

OREGON PUBLIC LAND CORNER REPORT / RESTORATION REPORT
Tillamook County Surveyor's Office

BOOK 8 239

SECTION: 28, 29, 32 AND 33	TOWNSHIP: 3 NORTH	RANGE: 10 West
COUNTY: Tillamook		DATE: 2/23/2026
CORNER DESIGNATION: Section corner common to sections 28, 29, 32 and 33, Township 3 North, Range 10 West, Willamette Meridian.		(Please check one)
		<input type="checkbox"/> Condition Report Only
		<input type="checkbox"/> Restoration
		<input checked="" type="checkbox"/> Rewitness
		<input type="checkbox"/> Unrecorded
		<input type="checkbox"/> Reset at surface
		<input type="checkbox"/> Referenced Out

Previous Rewitnesses, Restorations and Surveys, etc...
BLM field note volume: OR-R0053 Page 0056.00 (1857), Rewitness Book 10, pg. 83 (1891), Rewitness Bk. 1, Pg. 96 (1951), Amended in Rewitness Book 4, pg. 89 (1951), Rewitness Book 4, pg. 104 (1965), Rewitness Card # 151 (1969-1971), Rewitness Bk. 6, Pg. 247-248 (1983).

History, condition, and sources
1857 BLM field notes state that a post was set for the section corner and four bearing trees were established. 1891 Rewitness Book 10, pg. 83 states a post was found for the section corner, and 4 new bearing trees were established. 1951 Rewitness Book 4, pg. 89 a 1" iron rod for the section corner was set and 2 new bearing trees were established. 1965 Rewitness Book 4, pg. 104 established 2 new bearing trees. 1969 Rewitness Card #151 set a 2" iron pipe over the existing 1" iron rod with a 3" Tillamook County brass cap stamped "T3NR10 S29 S28 S32 S33 RS 793 1969" all bearing trees from previous rewitness were found. 1971 Rewitness Card #151 established 1 new bearing tree. In Rewitness Bk. 6, Pg. 248 (1983) Oregon Parks Dept. set 1 new accessory. In 2026 Tillamook County Surveyor's Office found a 3" Tillamook County Brass Cap in concrete and stamped as shown hereon. Found accessories are listed below.

Found: 21" dia. pine N70°E 54.55' (Rewitness Card #151 1971, 16" dia. pine N70°E 54.55') (Rewitness Bk. 6, Pg. 248, 18" dia. pine N82°E 55.5')

Found: orange carsonite post North 2.30' (Rewitness Bk. 6, Pg. 248, 7' fiberglass post North 2.0')

New accessories set:

The Monument was tied conventionally using GPS control in Oregon North Zone NAD 83/91 grid coordinates in US Survey feet. Coordinates provided hereon are given in WGS 84 Latitude and Longitude.

Latitude: 45°42'39.67541"
Longitude: -123°55'34.39917"

Pine 19" dia. N76°E 5.76' scribed "XBT" nail with washer between the B and the T. Measurement is to 80d nail at side center of tree.

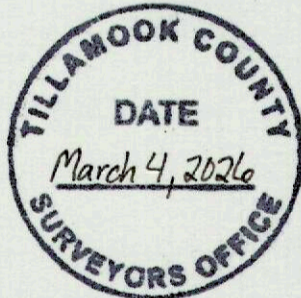

Pictures of Found Monuments:



Location: In the NE corner of upper transfer station parking lot approximately 30' down a sand hill.

Tillamook County Surveyor office: 1510 3rd Street Suite C, Tillamook, OR. 97141

Party Chief: Travis Porter, Tillamook County Survey Technician III

Witnesses: Michael Rice PLS 86926, Tillamook County Surveyor
Kael Poklikuha, Tillamook County Survey Technician II

Notes: Digital images taken of monument and accessories.

SURVEYOR'S SEAL



BOOK 8 239